

## Sidestack Assembly Instructions

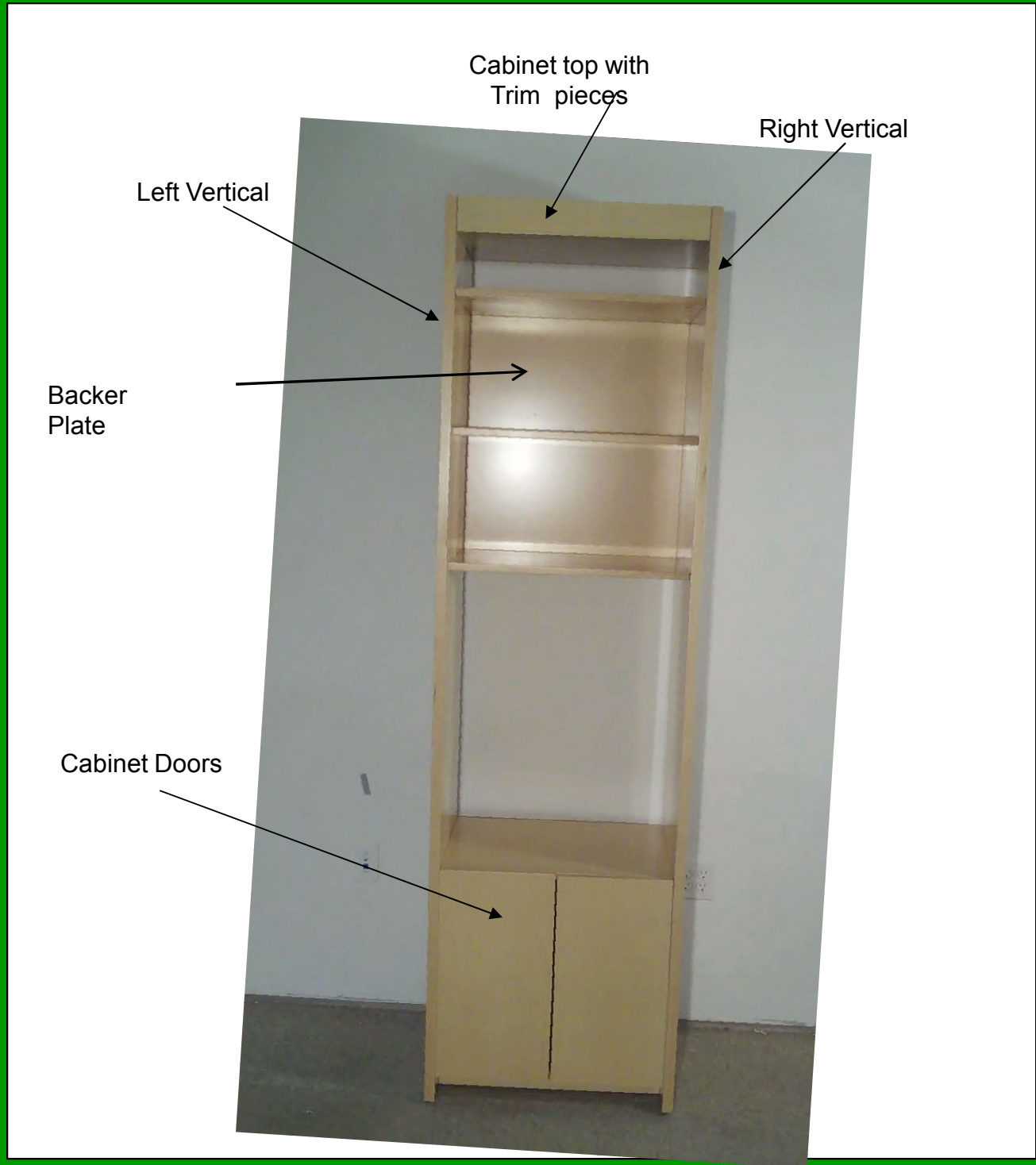

## Sidestack Assembly Instructions



The Sidestack will be packed in 3 boxes marked Sidestack box 1 of 3, 2 of 3 and 3 of 3



Required tools. Standard Screw driver, a Hammer, and a Cordless Drill with a Phillips bit.



Box 1 contains all of the shelves top and bottom trim and a bag with all of the hardware you will need.



Box 2 contains the 2 Verticals that make up the both sides of the Sidestack



Box 3 will have the 2 back pieces for the Sidestack as well as the doors for the front of the unit.



Open Hardware bag and separate all the hardware into groups. The 6 items you will have are KD pins, Dowel Pins, KD Locks, a bag of screws for attaching the back panel. 2 hinges for the doors.

## Sidestack Assembly Instructions

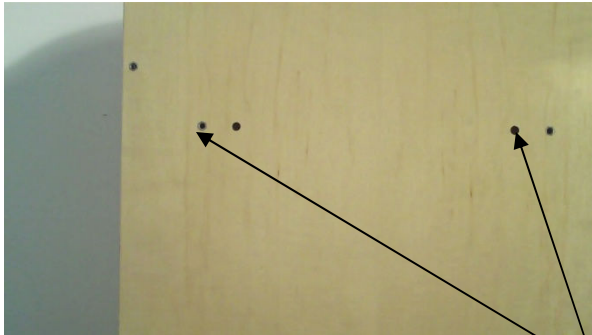

Lay the 2 Verticals ( box 2) on the floor with the beveled edges towards the bottom. There are 2 size holes in the Verticals. Screw in the KD Pins in threaded holes. The Dowel Pins fit into the none threaded holes.



Make sure that all of the KD Pins are tight . Then lightly tap all of the Dowel Pins in with the Hammer.



Finally screw in the feet on the bottom of the Verticals. They should be all the way in but not tight. They are now ready for assembly.



Open Box 1 lay out all of the shelves on the floor.

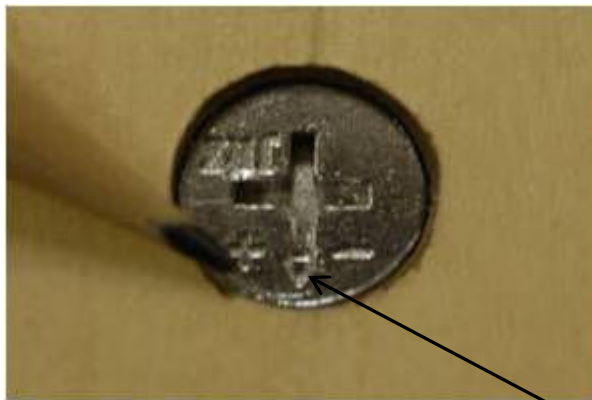

Insert all of the KD Locks as shown with the arrow pointing to the opening where KD Pins will be inserted. Repeat this process for all of the pieces in box 1. You are now ready for Assembly.



First find the bottom of cabinet. It has off set KD Locks for the bottom trim pieces. Screw in KD Pins and slide the pins into position to attach. Secure trim by using the screw driver to lock the KD Locks.

## Sidestack Assembly Instructions



Next locate the top of the cabinet. Screw in the KD Pins to the Trim. Then line up pins and slide into place.

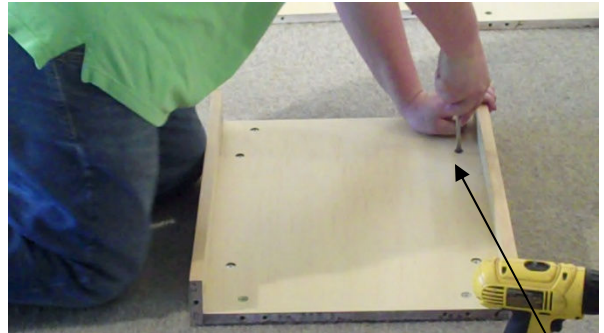

Once again tighten by turning the KD Locks with the Standard Screw Driver. Make sure that the trim pieces are secured into place.



Lift the Left Vertical up and insert the KD Pins as well as the Dowel Pins into the top of the cabinet. DO NOT TIGHTEN THE KD LOCKS.

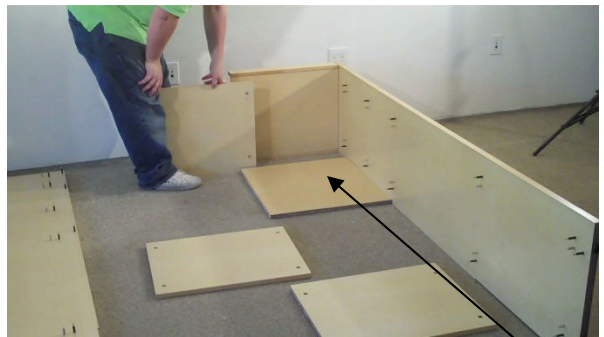

Next, slide the Backer Plate for the 3 shelves into place. Once complete locate the 3 shelves and slide these into position.

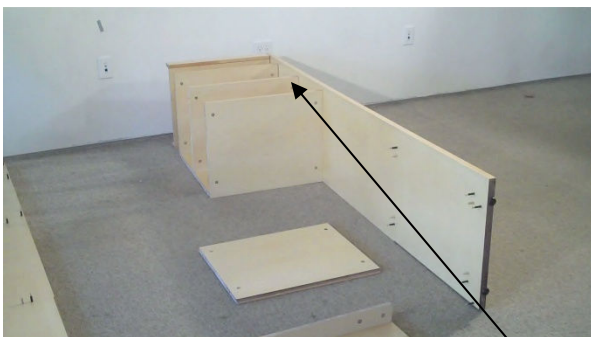

Make sure that that all shelves sit inside Vertical as shown. Please note that the shortest shelf of the 3 will be the one that sits on top of the Backer Plate. Make sure that all of the KD Locks are on the BOTTOM SIDE of shelves.



Add last shelf making sure that the groove is in the back of this so that the bottom cabinet Backer Plate can slide in. Then add the bottom shelf with the offset Trim piece in the front of the cabinet as shown.

## Sidestack Assembly Instructions



With help, position the right Vertical into place. Now that both Verticals are in place, tighten all KD Locks to secure Sidestack. Make sure that all fittings are snug. Make sure that there is not any space between the connections



Flip Sidestack over so that the back side is up. Slide in the back plate for the bottom in the grooves. Then secure with the small screws in plastic bag. Make sure all KD Locks are tight.



Flip Sidestack on its back so you can install the doors.



Open the 2 hardware packs with the hinges provided. Screw the hinges to the doors using the screws provided. Repeat on 2<sup>nd</sup> cabinet door.



Position cabinet door in place and screw in to secure.



Repeat on 2<sup>nd</sup> door. Square booth doors.